



# AL JAZEERAH MARINE

info@aljazeeraahmarine.com  
sales@aljazeeraahmarine.com

ADDRESS: EMIRATES INDUSTRIAL CITY SAJAA SHARJAH UAE

+971-54-7070379

www.aljazeeraahmarine.com



## 2. Specifications of Kenter Shackle

Materials:  
CM490/CM690  
Grade: U2/U3

### Key Features:

Made from heavy duty forged steel  
Used to join two anchor chains together  
Used in the marine industry to join together mooring and anchor chains  
Variety of sizes and weight available  
Supplied as an ex-stock item

AL JAZEERAH MARINE

# KANTER SHACKLE

The kenter shackle comprises of two separate halves which are joined together with a center chock and secure taper pin, which locks to the halves together. Kanters are used to join together majority of chains and typically in the marine industry they are used to join together anchor and mooring chains.

Dismantling the kenter joining shackle for re-use is straightforward. Simplify use a punch to drive out the taper pin, this will dislodge the lead pellet which holds the pin in place. Then tap the center chock away and the two halves will disassemble.

**AL JAZEERAH MARINE** supplies a wide range of Kenter Shackles to variety of sizes.

Dia (mm)	Dimensions (mm)					Weight (Kg)
	A	B	C	D	P	
16	96	67.2	24.3	18.6	21.4	0.62
17	102	71.4	25.84	17	68	0.82
19	114	79.8	28.88	19	76	1
20.5	123	86.1	31.16	20.5	82	1.35
22	132	92.4	33.44	22	88	1.6
24	144	100.8	36.48	24	96	2
26	156	109.2	39.52	26	104	2.7
28	168	117.6	42.56	28	112	3.3
30	180	126	45.6	30	120	3.9
32	192	134.4	48.64	32	128	4.6
34	204	142.8	51.68	34	136	5.8
36	216	151.2	54.72	36	144	6.6
38	228	159.6	57.76	38	152	7.8
40	240	168	60.8	40	160	9.1
42	252	176.4	63.84	42	168	10.5
44	264	184.8	66.88	44	176	12.2
46	276	193.2	69.92	46	184	14
48	288	201.6	72.96	48	192	16
50	300	210	76	50	200	18
52	312	218.4	79.04	52	208	20
54	324	226.8	82.08	54	216	21
56	336	235.2	85.12	56	224	24
58	348	243.6	88.16	58	232	28
60	360	252	91.2	60	240	28
62	372	260.4	94.24	62	248	33
64	384	268.8	97.28	64	256	38
66	396	277.2	100.32	66	264	38
68	408	285.6	103.36	68	272	44
70	420	294	106.4	70	280	44
74	444	310.8	112.48	74	296	50
76	456	319.2	115.52	76	304	58
81	486	340.2	123.12	81	324	74
84	504	352.8	127.68	84	336	84
87	522	365.4	132.24	87	348	94
90	540	378	136.8	90	360	105
92	552	386.4	139.84	92	368	105
95	570	399	144.4	95	380	115
97	582	407.4	147.44	97	388	135
100	600	420	152	100	400	150
102	612	428.4	155.04	102	408	150

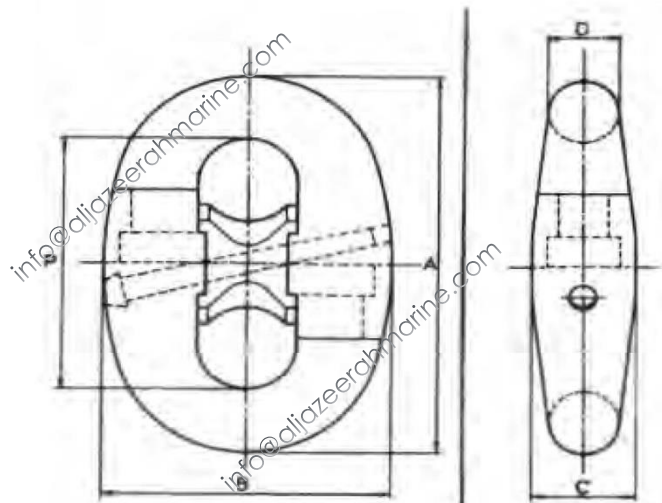

A = 6d  
B = 4.2d  
C = 1.52d  
D = 1d  
P = 4d

**AL JAZEERAH MARINE**  
Contact: info@aljazeeraahmarine.com  
Whatsapp: +971559047168  
www.aljazeeraahmarine.com  
Address: New Emirates Industrial City, Saja Sharjah UAE.

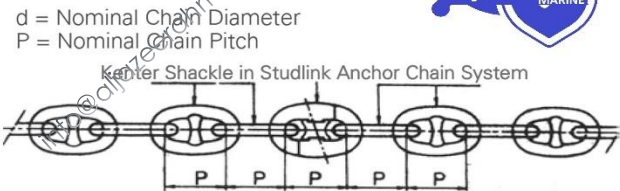

### Features

- One of the longest lasting removable connections for chain.
- The design is type approved by ABS, DNV and LR.

Trident Thin Slimline Kenter shackles also available upon request.

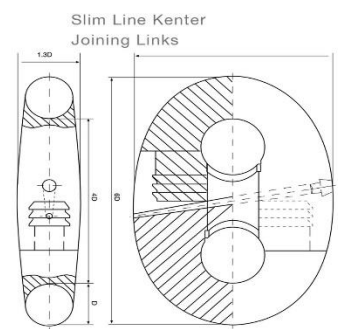

d = Nominal Chain Diameter

www.aljazeeraahmarine.com

www.aljazeeraahmarine.com